

# parcelas 400 C-D-E-F

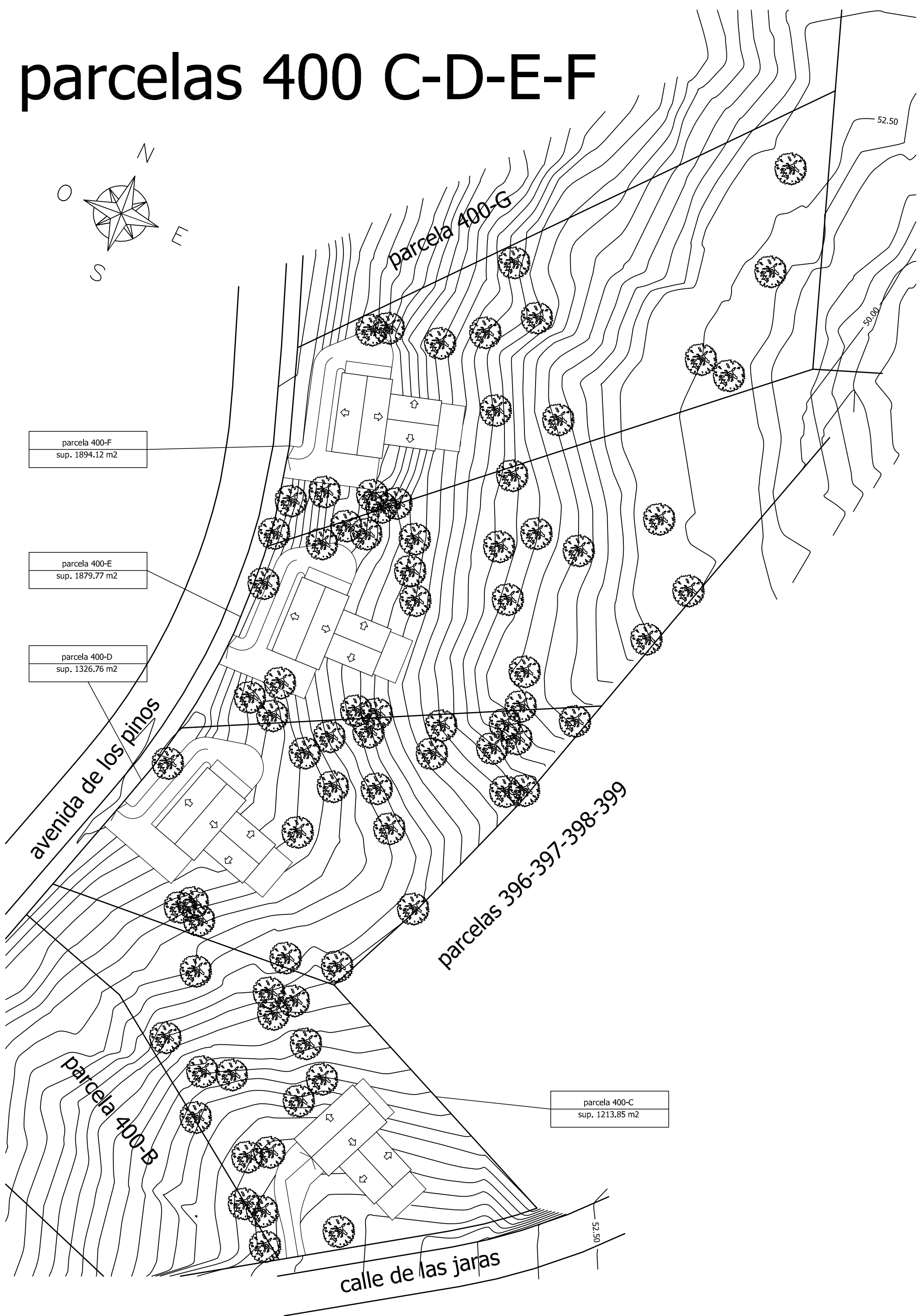
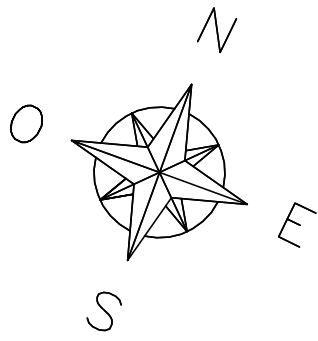

parcela 400-F  
sup. 1894.12 m<sup>2</sup>

parcela 400-E  
sup. 1879.77 m<sup>2</sup>

parcela 400-D  
sup. 1326.76 m<sup>2</sup>

avenida de los pinos

parcela 400-G

parcelas 396-397-398-399

parcela 400-B

parcela 400-C  
sup. 1213.85 m<sup>2</sup>

calle de las jaras

52.50

52.50

50.00